

# D.I.WIRE PRO

BY PENSALABS

INTRODUCING THE D.I.WIRE PRO,  
our newest CNC wire bender, offering the kind of  
power, speed, and precision that professionals need.

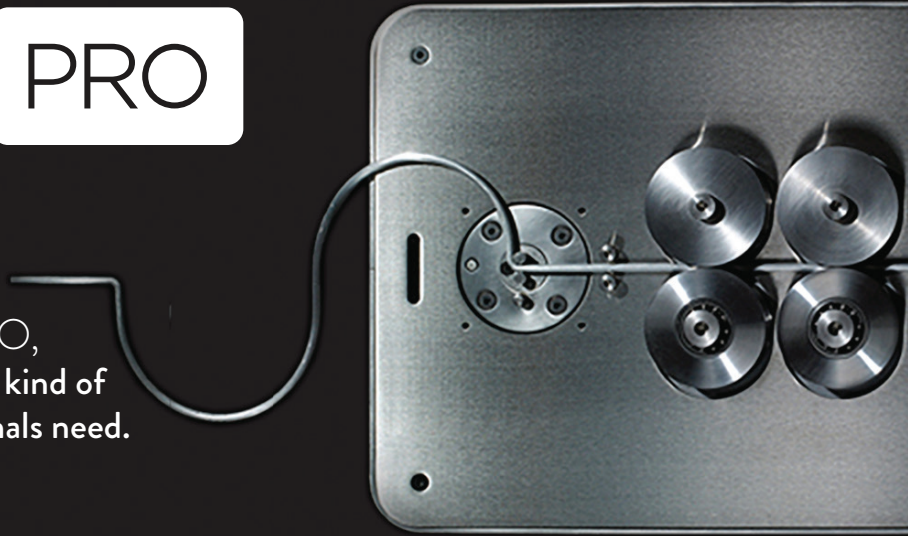

## WHAT CAN THE D.I.WIRE PRO DO FOR ME ?

Fully configurable and affordable, the D.I.Wire Pro solves your prototyping or small batch production needs.

- **INCREASE PRODUCTIVITY**  
Achieve more throughput per person.
- **INCREASE ACCURACY AND REPEATABILITY**  
Eliminate operator fatigue, error.
- **CAPTURES EXPERT KNOWLEDGE AND SKILL**  
New employees are productive right away.
- **SAVE MONEY AND TIME**  
Run small jobs yourself instead of contracting.
- **PERFECT PROTOTYPE**  
Before setting up a large production machine.

The bend mechanism that delivers smooth, tight radius curves — from fine orthodontic retainer wire to stainless steel parts.



## BASIC TECH SPECS

### Capabilities & Requirements

#### WIRE CAPABILITIES

Wire diameters: choose from 0.028" to 0.188" (0.7-4.8mm).

Maximum bend angle: 180°.

#### MATERIALS

A range of materials, from stainless steel to high carbon steel, low carbon steel, copper, brass, jacked wire, strap and aluminum.

#### SOFTWARE

Software included - the software interprets vectors, scripts or G-code, while compensating for the wire properties to create accurate parts.

#### POSITION ACCURACY

Feed: +/- 0.004" (0.1mm)

Bend Pin: +/-0.5°

Feed rate: about an inch per second

#### MACHINE

Dimensions: 16.25" x 11.25" x 13" (41 x 29 x 33 cm)

Weight: 100 lbs (Shipping Weight: 125 lbs)

Operating Temperature: 15-30°C, 59-86°F

Power Req: 100-240 V, 1.8 A, 50/60 Hz

Contact - For more information or to place an order, please email [info@aetlabs.com](mailto:info@aetlabs.com)

AET Labs

Learn more @ [PENSALABS.COM](http://PENSALABS.COM)

## HOW DOES IT WORK?

The workflow for D.I.Wire PRO is simple and straightforward.



### 1 DRAW CURVE

Use any 2D vector creation software to design your shape. Create SVG from your CAD or design in Wireware.

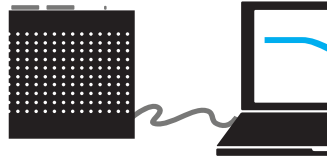

### 2 CONNECT VIA USB & OPEN WIREWARE

Connect D.I.Wire PRO and computer via USB and open Wireware to start a new bend project or open saved bends.

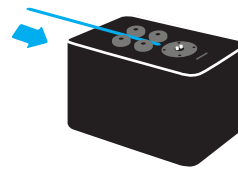

### 3 LOAD WIRE

Load your wire. DIWire PRO allows you to create custom material profiles that compensate for each material's properties.

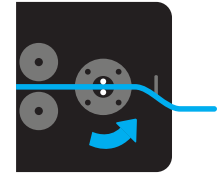

### 4 BEND

DIWire PRO makes bump bends, smooth curves, and 3D bends using manual rotations.

## HOW DO I USE WIREWARE?

The software is easy to use and allows for high level of control when needed.

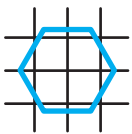

### PATH MODE

Path Mode - create shapes or import an SVG file. You can manipulate points using an interactive interface to adjust scale, feed length, bend angles, and curve resolution.



### SCRIPT MODE

Script Mode - program shapes using conversational script commands that compensate for the material properties, or directly control the machine using G-code.



### CALIBRATION MODE

Calibration Mode - learn and save the material's spring back properties to create accurate parts.

## HOW IS THE D.I.WIRE PRO DIFFERENT FROM THE D.I.WIRE?

The D.I.Wire PRO is designed with professional applications in mind.

- **MORE POWER:** bend stainless steel up to 0.188".
- **MORE MATERIAL OPTIONS:** customizable for wire sizes from 0.028" to 0.188", aluminum, brass, variety of steels, jacketed, and more.
- **MORE SHAPE CAPABILITIES:** bend up to 180° with close parallels; smooth curves can be coded for repeatability, sharper inside radii.
- **MORE OPTIONS FOR MATERIAL PROFILES:** customizable bend pins, mandrels, and more; can work with round or rectangular wire, and customizable for strap or tube.